

## 0.5kW Mini Oil Filled Radiator



### IG0500

Batch code:

**IMPORTANT:** THIS PRODUCT IS ONLY SUITABLE FOR WELL INSULATED SPACES OR OCCASIONAL USE

**Please read these instructions carefully before use and retain for future reference**

**Before switching on your appliance,  
always check for any damage which may have been caused in transit**

# CONTENTS

Safety instructions..... 3-4  
Specifications..... 4  
Technical Specifications..... 5  
Appliance Overview ..... 6  
Operation instructions ..... 6-7  
Cleaning & Maintenance ..... 7  
Plug Fuse Replacement ..... 7  
Troubleshooting..... 8  
Disposal information ..... 8  
Igenix Warranty ..... 10-11

## SAFETY INSTRUCTIONS

**Important:** Read and follow all of the instructions even if you feel you are familiar with the product, and find a place to keep this manual handy for future reference.

1. This appliance can be used by children aged from 8 years and above if they have been given supervision or instruction concerning the use of the appliance in a safe way and understand the hazards involved.
2. Cleaning and user maintenance shall not be made by children unless they are older than 8 years and supervised.
3. Keep the appliance and its cord out of reach of children aged less than 8 years.
4. Children shall not play with the appliance.
5. Appliances can be used by persons with reduced physical, sensory or mental capabilities or lack of experience and knowledge if they have been given supervision or instruction concerning use of the appliance in a safe way and understand the hazards involved.
6. Do not immerse the radiator or cord in water or any other liquid. Do not use in a bathroom, near water, or outdoors.
7. When the radiator is turned on for the first time, operate it at maximum temperature for at least 2 hours. During this time, make sure you are in a well ventilated area while the “new smell” is burnt off. This is completely normal and is not a cause for concern.
8. It is normal for the radiator to make “cracking” noises when it is heating up and cooling down.
9. Do not use the radiator for anything other than its intended use.
10. Never leave the radiator unattended whilst in use.
11. Do not pull on the cord to disconnect the plug from the wall socket.
12. Do not use the radiator to dry washing.

13. Do not use the radiator if the power cord or plug is damaged.
14. Do not replace the power cord or any other parts yourself.
15. Never rest the power cable on the hot fins of the radiator.
16. Always ensure that the radiator is positioned at least 50cm away from furniture or other objects.
17. The radiator should not be used if it has been dropped or if there are visible signs of damage.
18. This radiator is for household indoor use only. Never use it outdoors.
19. Never use the radiator on its side; it must always be used upright.
20. Before moving or attempting to clean the radiator, allow it to cool down completely.
21. The radiator should not be placed directly under a fixed power socket.
22. The radiator is filled with a precise quantity of oil and repairs requiring it to be opened must be carried out by the manufacturer. If the radiator leaks, contact the manufacturer.
23. This product contains oil and must be disposed of correctly. Do not dispose with general household waste. Take it to your nearest waste management center for processing.
24. The use of an extension lead is not recommended, as overheating of the extension lead may occur during radiator operation.

## **SPECIFICATION**

Supply Voltage:	220-240V ~ 50Hz
Maximum Output:	500W

## Technical specification

Item	Symbol	Value	Unit
Heat output			
Nominal heat output	$P_{nom}$	0,225	kW
Minimum heat output (indicative)	$P_{min}$	0	kW
Minimum continuous heat output	$P_{max,c}$	0,225	kW
Auxiliary electricity consumption			
At nominal heat output	$eI_{max}$	N/A	kW
At minimum heat output	$eI_{min}$	N/A	kW
In standby mode	$eI_{sb}$	N/A	kW

Item	Unit
Type of heat input, for electric storage local space heaters only (select one)	
manual heat charge control, with integrated thermostat	N/A
manual heat charge control with room and/or outdoor temperature feedback	N/A
electronic heat charge control with room and/or outdoor temperature feedback	N/A
fan assisted heat output	N/A
Type of heat output/room temperature control (select one)	
single stage heat output and no room temperature control	[no]
Two or more manual stages, no room temperature control	[no]
with mechanic thermostat room temperature control	[yes]
with electronic room temperature control	[no]
electronic room temperature control plus day timer	[no]
electronic room temperature control plus week timer	[no]
Other control options (multiple selections possible)	
room temperature control, with presence detection	[no]
room temperature control, with open window detection	[no]
with distance control option	[no]
with adaptive start control	[no]
with working time limitation	[no]
with black bulb sensor	[no]

# APPLIANCE OVERVIEW

Figure 1.

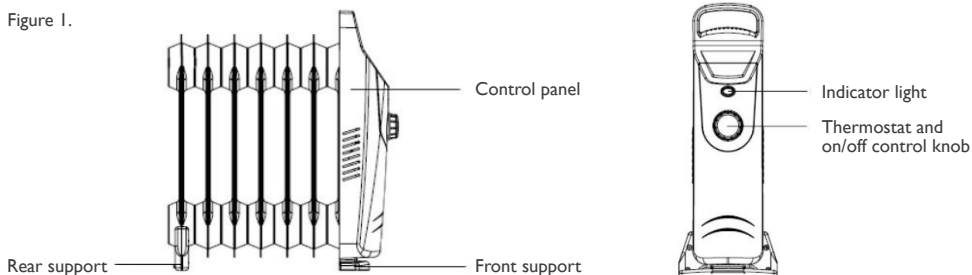

## Assembly method



Figure 2.

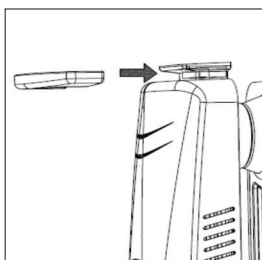

Figure 3.

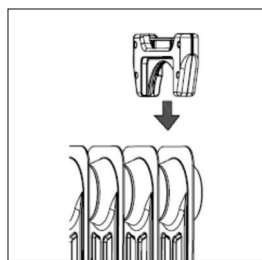

Figure 4.

Take out the radiator and all the parts from packing carton.

1. Turn the radiator upside down, as shown in Figure 2
2. Insert front supporting foot into the slot on the control panel, as shown in figure 3
3. Clip in the back foot along the slot of the last radiator fin, as shown in figure 4
4. Finally, turn the correct way up to stand on its feet.

# OPERATING INSTRUCTIONS

## IMPORTANT

When the radiator is in use, it should always be kept vertical (handle should be at the top). Putting the radiator in any other position could be dangerous and cause a potential fire hazard.

## Using your Radiator for the First Time

- When the radiator is turned on for the first time, operate at its maximum heat setting for at least two hours. Ensure you are in a well ventilated area during this time as the heater will give off a “new” smell. This is completely normal.
- The radiator will make cracking noises when it is first turned on and when it is turned off and cooling down.

### Location of the Radiator

- The radiator should be positioned where you most need the warmth.
- It is recommended to place the radiator underneath the coldest window in the room as this helps to increase the convective movement of the heat.
- Do not locate the radiator underneath a fixed power point.
- Always ensure that the radiator is placed at least 50cm away from furniture, curtains, walls etc.

### Plugging in the Radiator

Before plugging the radiator into the mains, ensure that your supply voltage is the same as what is shown on the rating plate of the radiator. Try to avoid contact between the radiator and clothes, household linen, furniture, inflammable material and the power socket.

### Turning on and Using the Radiator

1. Turn on the radiator by turning the control knob clockwise.
2. Set the thermostat knob to the MAX setting.
3. When the desired room temperature has been reached, turn back the thermostat dial until the indicator lamp goes out.
4. To turn the radiator off, turn the knob anti-clockwise until in the 'Off' position. Never leave plugged in when not in use.

## CLEANING AND MAINTENANCE

Before attempting any cleaning or maintenance on the radiator, allow it to cool completely and ensure that the plug is removed from the socket.

To clean the radiator, use a soft damp cloth without any abrasives or detergents on. If the radiator is not going to be used for a long period of time, wrap the cable around the cable tidy and store the radiator in a dry place. Storing the radiator in a damp environment could cause the radiator to rust and/or will effect the electronics in the radiator which is not covered by your warranty.

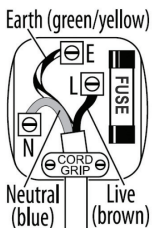

### Fuse Replacement (Class I)

This appliance must be earthed. Remove the central screw on the plug and open the shell. Take out the fuse and replace with a new fuse of the same Amp. Install the shell again and tighten the screws.

## TROUBLESHOOTING

If you are having problems with your appliance, please use our troubleshooting guide below. If you are unable to resolve the issue using the guide please ring our Customer Service Department on 01473 271 272. Please have the model code, batch number and purchase information available.

Problem	Possible Cause	Solution
The radiator does not work.	1. Not properly plugged into the mains wall socket. 2. No electricity in the mains wall socket.	1. Plug in firmly. 2. Check fuse or breaker.
The room is too cold.	1. Thermostat is set too low. 2. Draft from windows or door.	1. Turn up the thermostat. 2. Block up any drafts with draft excluders.
The room is too hot.	1. Thermostat is set too high.	1. Turn the Thermostat down to reduce the room temperature.

## DISPOSAL INFORMATION

The European Directive 2012/19/EU on Waste Electrical and Electronic Equipment (WEEE), requires that old household electrical appliances must not be disposed of in normal unsorted municipal waste.



Old appliances must be collected separately in order to optimise the recovery and recycling of the materials they contain and reduce the impact on human health and the environment.

The crossed out “wheeled bin” symbol on the product reminds you of your obligation, that when you dispose of the appliance it must be separately collected. Consumers should contact their local authority or retailer for information concerning the correct disposal of their old appliance.







## Igenix Warranty Terms & Conditions

This product is guaranteed for a period of 12 months as standard from the date of purchase against mechanical and electrical defects. You can extend your warranty for a further 12 months by registering your product.

Upon registration we will cover your product for a period of 24 months from the original purchase date against any mechanical or electrical defects.

To qualify for the warranty, the product must be used for domestic household use only and in accordance with the instructions in the user manual. Any misuse of the product will result in the warranty being void.

The warranty does not cover accidental damage, misuse, neglect, tampering or incorrect adjustment or installation.

The warranty will be rendered invalid if the product is resold, has had its serial number removed (or has an invalid serial number), or if an unauthorised person has carried out any repairs or alterations.

The warranty does not cover accessories or consumable parts that require replacement under normal use. This includes shelving, dials, filters, belts and trays etc.

In the unlikely event of a breakdown please refer to the Troubleshooting guide in your user manual and check all plugs, fuses and the electricity supply.

If you still require assistance please contact our Customer Service department on **01473 271 272** or write to us at the following address:

**Customer Service Department  
38 Bluestem Road, Ransomes Europark  
Ipswich, IP3 9RR**

Please quote the Product Code which begins 'IG' or 'DF' and the Batch Code beginning '5' and give details of the exact fault. We will then decide whether to repair or replace the item.

Before we arrange the repair or replacement you will be required to return a copy of your proof of purchase. Please retain your original.

If an item is replaced within the agreed warranty period, the warranty for the replacement item will be calculated from the purchase date of the original.

In the event that the product is inspected and no fault is found or the product is not within the guarantee period you will be charged for the repair and any carriage costs.

# igenix

## Thank you for choosing Igenix

As a valued customer we would like to offer you a FREE 2 year warranty to cover your product against any electrical or mechanical defects.

This means that in the unlikely event you develop a fault or problem with your product we will happily repair or replace the item free of charge.

To qualify for the 2 year warranty you must register your product within 30 days of purchase. The full Terms & Conditions of our warranty policy are shown on the opposite page. They are also available on our website. **www.igenix.co.uk**

To register your product, please complete all sections of the form below and return to us at the following address: Igenix, 38 Bluestem Road, Ransomes Europark, Ipswich, IP3 9RR.

Alternatively you can visit the Igenix website and complete the form online.

### Customer Details:

Title: \_\_\_\_\_ First Name \_\_\_\_\_ Surname: \_\_\_\_\_

Address: \_\_\_\_\_

Post Code: \_\_\_\_\_

Email: \_\_\_\_\_

Telephone: \_\_\_\_\_

### Product Information:

Product Code (Beginning IG or DF): \_\_\_\_\_ Product Description: \_\_\_\_\_

Batch Number (Beginning 5): \_\_\_\_\_ Serial Number (if applicable): \_\_\_\_\_

Date of Purchase: \_\_\_\_\_

Retailer Name: \_\_\_\_\_

Retailer Location: \_\_\_\_\_

Please tick here to confirm you have read and accept our Terms & Conditions

Please tick here if you DO NOT wish to receive marketing information from us

Customer Signature: \_\_\_\_\_ Date: \_\_\_\_\_

# **igenix**

**38 Bluestem Road, Ransomes Europark, Ipswich, IP3 9RR**

**Tel. 01473 271 272**

Disclaimer: Igenix operate a policy of continual improvement and development.  
We therefore reserve the right to change/alter the specification and appearance of our appliances without prior notice.  
All diagrams and images shown in this manual are for illustration purposes only.